

Height adjustment

There are 3 different sizes for the Adjusting Blocks, which can be combined to raise the Pedal height to 7 different levels from 2.5cm to 17.5cm. (If you want to further increase the height, you can purchase an additional 5 cm Adjusting Block (M) separately which can increase the height to 20 cm/22.5 cm.

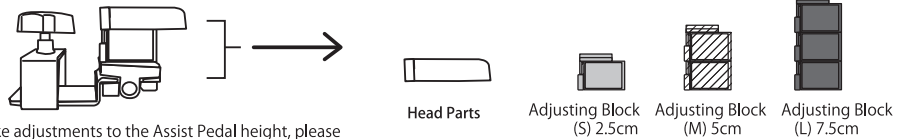

To make adjustments to the Assist Pedal height, please refer to the diagrams below.

※ The Assist Pedal height 0 is the height of the top of the piano pedal.

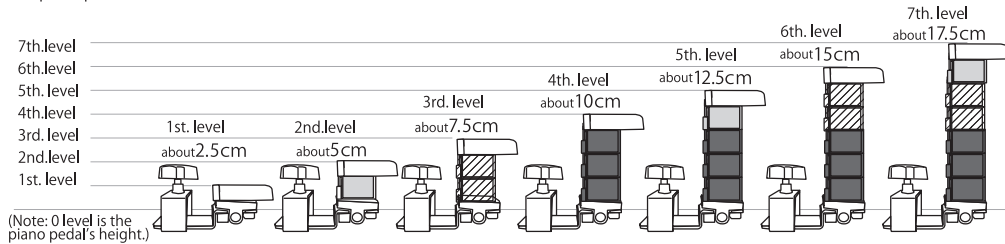

● Maintenance Instructions

- ◎ The needle punch cloth and rubber are perishable. Please replace these when they wear out. (The Rubber is synthetic and 1mm thick. For adhesion, please use instant glue. The needle punch cloth is 3mm thick and when replacing it, please use the adhesive Silex Bond.)
- ◎ Periodically grease the Mounting Knob's screw section and wipe off any excess oil.
- ◎ Please clean the rubber part with a neutral detergent to prevent slipping.
- ◎ The top section of the Adjusting Blocks that slide were treated with soap suds to ensure smooth installation. Please reapply soap suds to the sliding sections of the Adjusting Blocks if they do not slide smoothly.

※ Caution when using ※

- ◎ Please refrain from using the product for any purpose other than its intended use.
- ◎ Do not disassemble the pedal base.
- ◎ Do not use assist pedals higher than 22.5 cm
- ◎ Please handle with care as the metal corners may have burrs which can cause injury.
- ◎ If you loosen the Knob too much, you risk disconnecting the metal components.
- ◎ Please do not expose the plastic parts to direct sunlight as this will cause deterioration.

◎ When playing, always operate the pedals directly back and forth. Do not put your weight on the pedals or twist them from side to side when in use. This can damage the Assist Pedal or the piano's pedals.

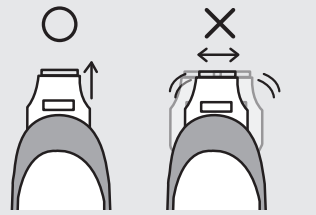

USER'S MANUAL

※ Before using the Assist High Tool, please read this user's manual in order to use it correctly. Also, please keep the manual for your future reference.

Assist Pedal (23-ASP)

◎ For smoother pedalling, the Assist Pedals are designed to move slightly backwards and forwards when in use. (they can also be adjusted, see inside this manual).

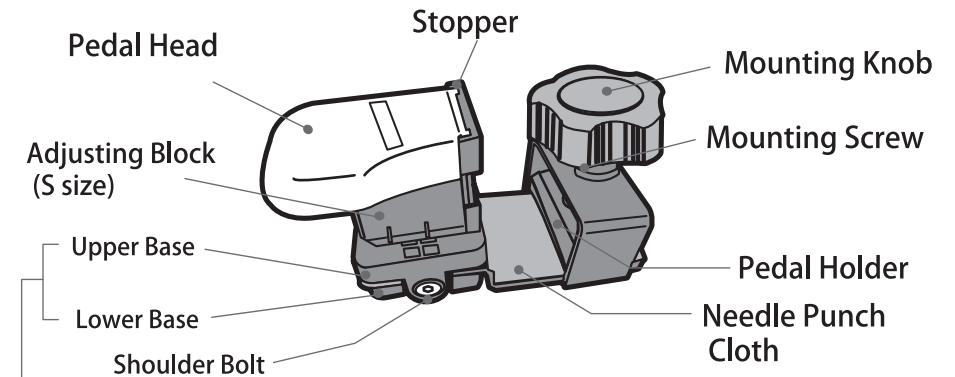

Details of Pedal Base

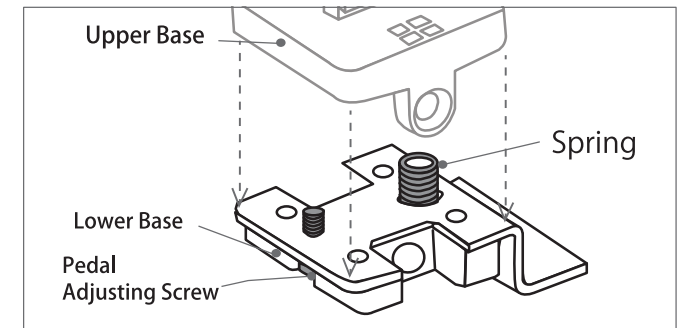

The Adjusting Blocks are available in three different sizes and can be combined to adjust the height to seven levels from 2.5 cm to 17.5 cm. (See reverse side for assembly instructions)

Locked Position

Open Position

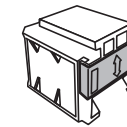
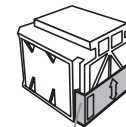

Stopper

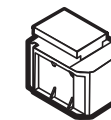

Adjusting Block (S)
Height 2.5cm

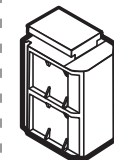

Adjusting Block (M)
Height 5cm

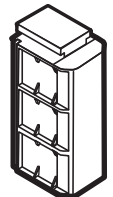

Adjusting Block (L)
Height 7.5cm

Adjusting Blocks come with the product

How to Assemble the Assist Pedal

© When the Assist Pedal is unpacked, its height is set to the second level (5cm).

1 Divide the Assist Pedal into three parts.

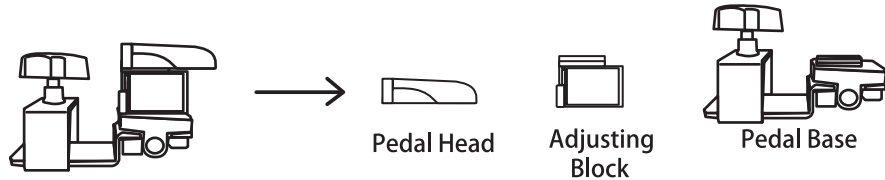

Lift the Stoppers on the Pedal Head and the Adjusting Block upwards then pull them out in the direction of the arrow shown on the right.

Example: When you want to remove the Head

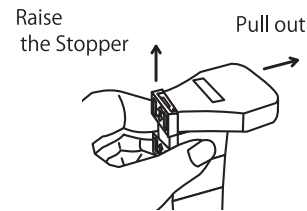

2 Fix the Pedal Head and the Adjusting Blocks to the same height as the Assist Stool. (See reverse side for assembling instructions)

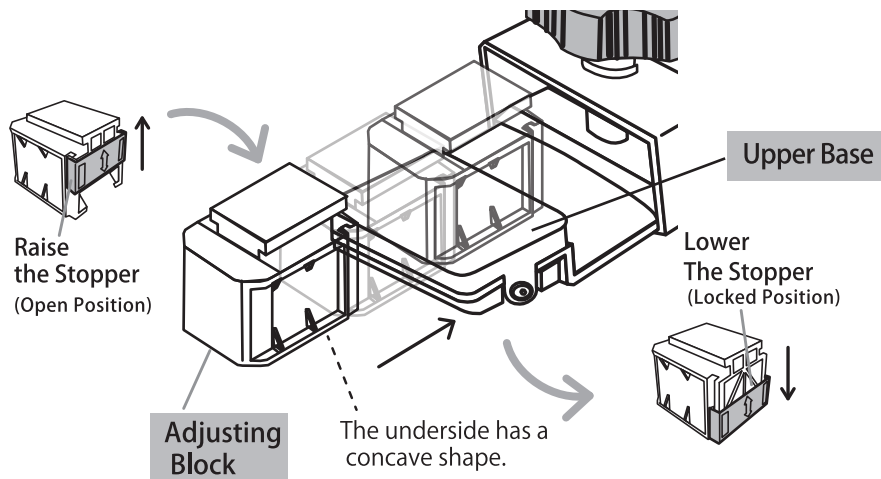

Raise the Stopper at the back of the Adjusting Block, align the concave shape of the Adjusting Block with the convex shape of the Upper Base and insert the Adjusting Block as far as possible, then lower the Stopper to lock.

3 Fix the height adjusted Assist Pedal to the piano pedal.

Before attaching the Assist Pedal

1. Remove any covering (vinyl etc.) from the piano pedal.
2. Wipe off any oil or wax that may have been applied to the surface of the pedal with a neutral detergent.

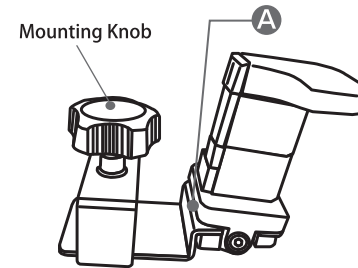

Insert the piano pedal so that the tip does not touch the surface of A, and then turn the Mounting Knob to fix it.

After checking the motion, adjust the pedalling action if necessary. (The details and the adjustment instructions are written below)

Pedalling adjustment

The Pedalling adjustment function is designed to make pedalling better and easier.

※By using indoor shoes, you can pedal more smoothly.※

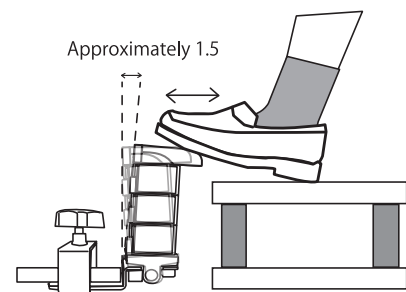

When pedalling, the Assist Pedals are designed to move back and forth by approximately 1.5 cm. (in the case of the 4th level height). This is for smoother pedalling

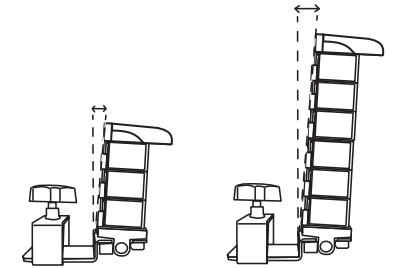

In the case of the 4th level (10 cm)

In the case of the 7th level (17.5 cm)

If the Assist Pedal is set in a high position (see the above diagram), or if you want to stop the back and forth movement of the Assist Pedal to suit your individual pedalling preferences, you can make the following adjustments.

How to adjust

By tightening or loosening the Pedal Adjustment Screw on the back of the pedal with a screwdriver, you can adjust the degree of back and forth movement. You can also tighten the Screw all the way to stop movement. (Please have a screwdriver handy)

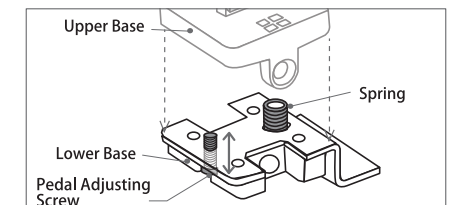
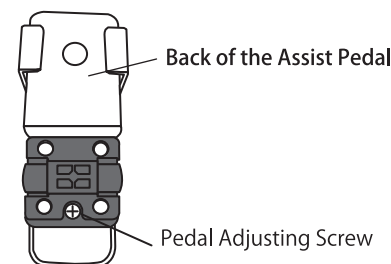

By tightening the Pedal Adjusting Screw, the back and forth movement of the pedal can be adjusted.